

  
NEW ZEALAND MEDICAL ASSOCIATION  
**Rotorua GP CME 2010**  
General Practice Conference & Medical Exhibition



Sponsorship & Exhibition Prospectus  
Energy Events Centre, Rotorua  
10-13 June 2010



## About GP CME

GP CME (General Practice Conference & Medical Exhibition) is run in conjunction with the New Zealand Medical Association. The meeting has a strong reputation for short, sharp and to the point clinical content relevant to daily practice. Each session has 2-3 key 'take-home' messages to change clinical behaviour immediately.

The meeting is endorsed for CME and MOPS purposes by the RNZCGP. Approximately 20% of New Zealand's GP's attend GP CME, from the following regions:

Region	Number	Percentage %
AUCKLAND	203	27%
BAY OF PLENTY	167	22%
WAIKATO	89	12%
SOUTH ISLAND	75	10%
NORTHLAND	50	7%
WELLINGTON	48	6%
EASTLAND/HAWKES BAY	37	5%
MANAWATU/WAIRARAPA	34	5%
CENTRAL	32	4%
RIVER REGION	23	2%
INTERNATIONAL	2	1%
<b>TOTAL</b>	<b>760<sup>1</sup></b>	

<sup>1</sup>Total includes GPs, RNs and participating speakers at GP CME 2009.

GP CME 2010 anticipates 400-500 GPs, 100-120 RNs and 40-60 Practice Managers

All General Practitioners, Registrars, Registered Nurses and Practice Managers are invited to attend.

## Table of Contents

About .....	1
Invitation .....	3
Preliminary Programme .....	4
Sponsorship Options .....	6
Exhibition Layout .....	7
Products, Prizes & Competitions .....	9
Other Sponsorship Options .....	10
Exhibition Details .....	12
Cancellation	
Catering	
Internet Access	
Insurance	
Security	
Proceedings Ads	
CD Rom Content	
Registration/Accommodation	
Stand Equipment	
Delivery/Storage Details	
Timetable	
Application Form .....	15
Delivery Label .....	17





## Invitation

The Medical Exhibition is a major part of the conference, and gives delegates access to a wide General Practice product and service update in one location.

The meeting is known for its relaxed and collegial atmosphere amongst delegates and industry participants. This atmosphere is actively encouraged to maximize the benefits for both delegates and exhibitors.

The following product/service categories have been represented at previous exhibitions:

- Acne and Rosacea Management • Advisory Services
- Allergy • Amniotic Fluid leaks • Angina • Anti-fungals
- Appearance Medicine • Arthritis • Asthma & COPD
- Blood Pressure • Books • Breast Cancer • Cardiovascular
- CD Audio Sales • Cervical Screening • Compression Hosiery
- Depression • Dermatology • Diabetes • Diagnostics
- Eczema • Education • Electromedical Equipment
- Erectile Dysfunction • Fibre Supplement • Financial Services
- Furniture/Tables/Plinths • Hand Hygiene • Hypertension
- Immunisations/Vaccines • Incontinence • Infant Nutrition
- Infant Sleep • Infection Control

- Infectious Diseases - Hepatitis B and HIV • Insurance
- Melanoma • Menorrhagia • Minor Surgical Procedures
- Nasal Decongestant • Natural Health • Ophthalmology
- Osteoporosis • Pain Management • Pelvic Floor Prolapse
- Political Advocacy • Psoriasis • Pulse Oximetry
- Recruitment/Locum Work • Representation • Resuscitation
- Skincare • Sleep Apnoea • Smoking Cessation
- Software Vendors • Spirometry • Surgical Instruments
- Sutures • Telecommunications • Travel • Women's Health
- Wound care

If you are active in the General Practice market, GP CME provides access to a wide cross-section of practitioners, with clinically relevant content, over a compact time frame. Together with a collegial atmosphere, this meeting is not to be missed.



PRELIMINARY PROGRAMME

Optional Pre-conference Workshops

Thurs 10th June		WORKSHOPS Preliminary Day					
	W/Shop 1	W/Shop 2	W/Shop 3	W/Shop 4	W/Shop 5	W/Shop 6	
0830-1030	Basic Surgery 1 Pat Alley/Zac MPCs	Laser Safety Course 1 Lee Collins (4 hours)	Vasectomy 1 John Apps	Musculoskeletal Medicine 1 Ian Wallbridge	MPS Session Privacy Pitfalls- Practice Policies Hot Issues- What's new in the Medicolegal marketplace	ALS Course Level 7 (All day)	
1030-1100 MORNING TEA							
	W/Shop 7		W/Shop 8	W/Shop 9	W/Shop 10		
1100-1300	Advanced Surgery 1 Pat Alley/ZacPCS		Vasectomy 2 John Apps	Musculoskeletal Radiology 1 Phil Weeks	MPS Session 2 repeat Hot Issues- What's new in the Medicolegal marketplace		
1300-1400 LUNCH							
	W/Shop 11	W/Shop 12	W/Shop 13	W/Shop 14	W/Shop 15		
1400-1600	Basic Surgery 2 Pat Alley/ZacPCS	Laser Safety Course 2 Lee Collins (4 hours)	Suicide and Violence 1 Shailesh Kumar	Musculoskeletal Medicine 2 Ian Wallbridge	Dermoscopy 1 Amanda Oakley		
1600-1630 AFTERNOON TEA							
	W/Shop 16		W/Shop 17	W/Shop 18	W/Shop 19		
1630-1830	Advanced Surgery 2 Pat Alley/ZacPCS		Suicide and Violence 2 Shailesh Kumar	Musculoskeletal Radiology 2 Phil Weeks	Dermoscopy 2 Amanda Oakley		

General Practice Programme - Saturday

Saturday 12th June		General Practice Programme					
0700-1700	Registration	Breakfast Session - Topic to be Confirmed					
0715-0815	Main Session Lasers in Medicine	Breakout 11	Breakout 12	Breakout 13	Breakout 14	Breakout 15	Level 5 ACLS
0830-0845	Lasers in Medicine Lee Collins	Pathology Topic Paul Ockleford	Less Form Filling - MSD David Bratt	Insomnia and Circadian Dysrhythmia Alex Bartle	Interventions for Adolescent Substance Abuse Grant Christie	Healthline Ian St George	ACLS Course 2 0900-1300 Paramed 4 hours
0845-0900	Urology Mark Fraundorfer						
0900-0915	Diem Paul Le Grice						
0915-0930	Eyes Mike O'Rourke						
	Main Session Lasers in Medicine	Breakout 16	Breakout 17	Breakout 18	Breakout 19	Breakout 20	
0930-0945	Gynaecology Anil Sharma	Pathology Topic Paul Ockleford	Less Form Filling - MSD David Bratt	Insomnia and Circadian Dysrhythmia Alex Bartle	Interventions for Adolescent Substance Abuse Grant Christie	Healthline Ian St George	
0945-1000	Vascular Dave Ferrar						
1000-1015	Cardiology Warren Smith						
1000-1030	Discussion						
1030-1100 MORNING TEA							
1100-1155	Workshops (Choose 2 preferences) EEC = Energy Event Centre, Mill = Millennium Hotel						
EEC	WS 1	Hepatology 101				David Rowbotham	
EEC	WS 2	Eye Case Studies				Mike O'Rourke	
EEC	WS 3	QOL Issues in Males Hormone Rx				Mark Fraundorfer	
EEC	WS 4	Skin Cancer Surgery				Paul Le Grice	
EEC	WS 5	Menstrual Disorders and HPV				Anil Sharma	
EEC	WS 6	Occ Health Case Studies				Des Gorman	
Mill	WS 7	Oropharyngeal				Prof Laurie Walsh	
Mill	WS 8	Ultrasound in Primary care				Phil Weeks	
Mill	WS 9	Cervical Spine Tips				Ian Wallbridge	
Mill	WS 10	Vascular Doppler				CareMed	
1205-1300	Workshops repeated - Shuttle bus service operating between venues						
1300-1400 LUNCH							
1400-1455	Workshops (Choose 2 preferences) EEC = Energy Event Centre, Mill = Millennium Hotel						
EEC	WS 11	The Virtues of Fat				Ralph Bright	
EEC	WS 12	CVS Case Studies				Warren Smith	
EEC	WS 13	Immunisation Strategies				Nikki Turner	
EEC	WS 14	The Science of Happiness				Tony Fernando	
EEC	WS 15	Neonatal Pearls				Dave Bourchier	
EEC	WS 16	Abnormal Liver Function				Alasdair Patrick	
Mill	WS 17	Polypill Prevention of CVS Disease				Shaun Holt	
Mill	WS 18	Rheumatology Case Studies				Andrew Harrison	
Mill	WS 19	Hyperhidrosis				Dave Ferrar	
Mill	WS 20	Medtech Update				Medtech	
1505-1600	Workshops repeated - Shuttle bus service operating between venues						
1600-1630 AFTERNOON TEA							
1630-1730	How to series WS... (Choose 1 preference) EEC = Energy Event Centre, Mill = Millennium Hotel						
EEC	WS 21	How to... Interpreting ECGs				Warren Smith	
EEC	WS 22	How to... Trigger Point Needling				John Apps	
EEC	WS 23	How to... Help Sick Doctors				Pat Alley	
EEC	WS 24	How to... Manage Hepatitis B and C				David Rowbotham	
EEC	WS 25	How to...					
EEC	WS 26	How to... Stop Smoking				Rob Young	
Mill	WS 27	How to... Mirena/Pipelle/Pessaries				Anil Sharma	
Mill	WS 28	How to... Manage anxiety				Tony Fernando	
Mill	WS 29	How to... Spirometry and NO				McLaren medical	
Mill	WS 30	How to... Prescribe to the Elderly				Andrea Shirlcliffe	
1900-2400	Conference Dinner - Dine and Dance						

Practice Nurses Programme

Saturday 12th June		Practice Nurses Programme					
Coordinator - Mary Anne Cameron, New Zealand College of Practice Nurses, NZNO							
Registration							
0700-1700	Breakfast Session - Topic to be Confirmed						
0715-0815	Main Session	Breakout 11	Breakout 12	Breakout 13	Breakout 14	Breakout 15	
0830-0845	Lasers in Medicine Lee Collins	Pathology Topic Paul Ockleford	Less Form Filling - MSD David Bratt	Insomnia and Circadian Dysrhythmia Alex Bartle	Interventions for Adolescent Substance Abuse Grant Christie	Healthline Ian St George	
0845-0900	Urology Mark Fraundorfer						
0900-0915	Diem Paul Le Grice						
0915-0930	Eyes Mike O'Rourke						
	Main Session	Breakout 16	Breakout 17	Breakout 18	Breakout 19	Breakout 20	
0930-0945	Gynaecology Anil Sharma	Pathology Topic Paul Ockleford	Less Form Filling - MSD David Bratt	Insomnia and Circadian Dysrhythmia Alex Bartle	Interventions for Adolescent Substance Abuse Grant Christie	Healthline Ian St George	
0945-1000	Vascular Dave Ferrar						
1000-1015	Cardiology Warren Smith						
1000-1030	Discussion						
1030-1100 MORNING TEA							
1100-1200	Immunisation Workshop						Nikki Turner
1200-1230	Neonatal medicine						David Bourchier
1230-1300	Teenage Addiction						Grant Christie
1300-1400 LUNCH							
1400-1430	Men's Health						Mark Fraundorfer
1430-1500	Obesity						Richard Babor
1500-1600	Cx smears/Pipelle Workshop						Mary Birdsall
1600-1630 AFTERNOON TEA							
1630-1730	How to series WS... (Choose 1 preference) EEC = Energy Event Centre, Mill = Millennium Hotel						
EEC	WS 21	How to... Interpreting ECGs					Warren Smith
EEC	WS 22	How to... Trigger Point Needling					John Apps
EEC	WS 23	How to... Help Sick Doctors					Pat Alley
EEC	WS 24	How to... Manage Hepatitis B and C					David Rowbotham
EEC	WS 25	How to...					
EEC	WS 26	How to... Stop Smoking					Rob Young
Mill	WS 27	How to... Mirena/Pipelle/Pessaries					Anil Sharma
Mill	WS 28	How to... Manage anxiety					Tony Fernando
Mill	WS 29	How to... Spirometry and NO					McLaren medical
Mill	WS 30	How to... Prescribe to the Elderly					Andrea Shirlcliffe
1900-2400	Conference Dinner - Dine and Dance						

General Practice Programme - Friday

Friday 11th June		General Practice Programme					
0700-1700	Late Registration						
0815-0830	Welcome						
0830-0900	Primary Care in NZ - what's up?	Des Gorman					
0900-0925	Bowel Cancer Screening	Alasdair Patrick					
0925-0950	Percutaneous Valve Transplants	John Ormiston					
0950-1020	Reform and diversification of the NZ Health Workforce	Des Gorman					
1020-1030	Discussion						
1030-1100 MORNING TEA							
NZMA Medicopolitical Session							
Chairmans Address							
1100-1130	Political Debate						
1130-1230	Q&A Discussion						
1230-1300 LUNCH							
1300-1400	Main Session	Breakout 1	Breakout 2	Breakout 3	Breakout 4	Breakout 5	Level 5 ACLS
1400-1425	Eyes Mike O'Rourke	Money talks Westpac	Diabetes Brandon On-Walker Craig Burnett	GI tribits David Rowbotham	Are your Patients fit to fly? Claude Pretner	Smoking Cessation Rob Young	ACLS Course 1 1400-1800 Enmare 4 hours
1425-1450	What Matters in Kids Urology Mark Fraundorfer						
1450-1515	Safer Use of Medication Brian Almand/ Andi Shirlcliffe Abbott						
1515-1530	Discussion						
1600-1630 AFTERNOON TEA							
1600-1730	Main Session	Breakout 6	Breakout 7	Breakout 8	Breakout 9	Breakout 10	
1600-1625	Oral Health's Medical Impact Prof Laurie Walsh	Money talks Westpac	Diabetes Brandon On-Walker	GI tribits David Rowbotham	Are your Patients fit to fly? Claude Pretner	Smoking Cessation Rob Young	
1625-1650	Evidence Based Natural Healthcare Shawn Holt						
1650-1715	Stem Cells in Aging and Inflammatory Conditions Ralph Bright						
1715-1730	Discussion						
1800-1900	Welcome Cocktails - Medical Protection Society & Medical Assurance Society						
1915-2100	Merck Sharp & Dohme Symposium						

General Practice Programme - Sunday

Sunday 13th June		General Practice Programme					
0730-0830	Breakfast Session - Topic to be Confirmed						
0830-0900	Main Session	WS 31	WS 32	WS 33	WS 34	WS 35	Level 5 ACLS
0900-0925	The Upper GI Tract Alasdair Patrick	Gynae Topic Mary Birdsall	Vulval Disorders Amanda Oakley	How You can use Stem Cells Ralph Bright	Photodynamic Therapy Lee Collins	Wilderness Medicine John Apps	ACLS Course 4 0830-1230 Enmare 4 hours
0925-0950	New Joy for Cardiac Disease Warren Smith						
	Main Session	WS 31	WS 32	WS 33	WS 34	WS 35	
0925-0950	Hot Tips in Rheumatology Andrew Harrison	Gynae Topic Mary Birdsall	Vulval Disorders Amanda Oakley	How You can use Stem Cells Ralph Bright	Photodynamic Therapy Lee Collins		
0950-1010	Pelvic Floor Issues Anil Sharma						
1010-1025	Discussion						
1025-1030	Industry Prizes						
1030-1100 MORNING TEA							
1100-1130	Teenage Pretermers						Dave Bourchier
1130-1200	Overview talk						Paul Ockleford
1200-1230	Health for All in Aotearoa						Des Gorman
1230-1300	Clinical Quiz						Alasdair Patrick
1300	Conference Closes						





## Sponsorship

Platinum Sponsorship (limited to two companies) ..... \$17,500 +GST

Includes:

- triple stand space (9m x 2.4m),
- 5 complimentary rep registrations
- 5 complimentary tickets to the conference dinner
- 2 page (or DPS) colour ads in the conference proceedings (with placement preference),
- CD ROM content
- Satchel insert
- Full page advert in registration brochure x 2 (February & April Issues)
- Prize giving slot on Sun 13 June if awarding a conference prize
- Acknowledgement as the principal sponsor(s) for the meeting on:
  - website
  - delegate newsletters
  - conference registration brochure
  - onsite conference signage

Gold Sponsorship ..... \$10,500 +GST

Includes:

- triple stand space (9m x 2.4m),
- 4 complimentary company representative registrations,
- 1 page colour ad in Conference Proceedings,
- Satchel insert

Silver Sponsorship ..... \$ 6,750 +GST

Includes:

- double stand space (6m x 2.4m)
- 2 complimentary company representative registrations
- 1/2 page ad in Conference Proceedings

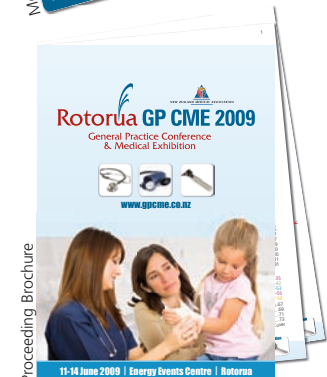

**Exhibition Space only** (Please note: See page 12 for contact details of exhibition supplier)

Single Stand Space ..... \$ 3,500 +GST

Includes: single stand space (3m x 1.8m), 1 complimentary company representative registration and colour 1/4 page ad in Conference Proceedings.

Table Space ..... \$ 2,000 +GST

Includes: single table space (2m x 1.2m), 1 complimentary company representative registration and colour 1/4 page ad in Conference Proceedings.

**Notes and participation inclusions:**

- All stand spaces are 3m x 1.8m.
- Trestle table (2m x 1.2m) and chairs can be arranged for space on request.
- Includes a list of the conference participants, with contact details of those who have given permission for name publication
- Acknowledgement on registration, website and proceedings of company participation



**Exhibition Map**

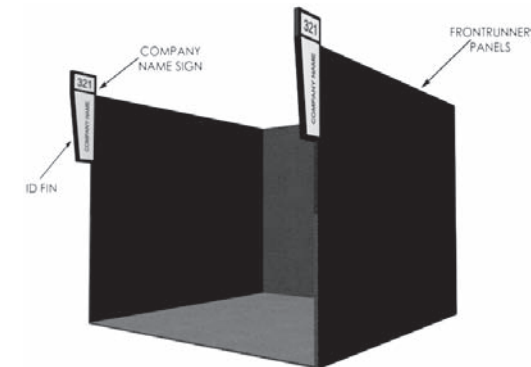
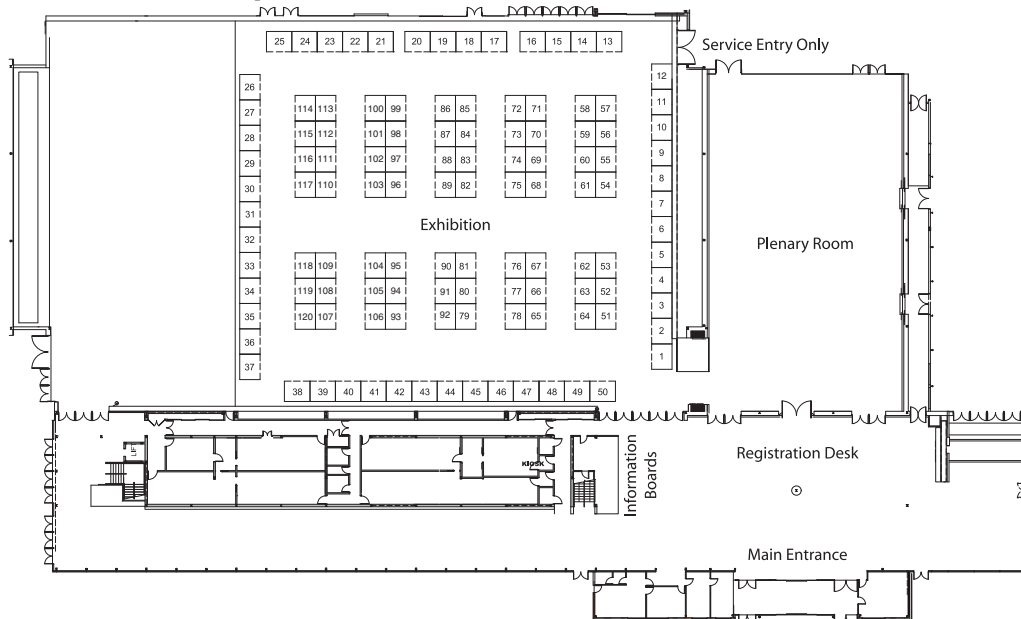

- Size:** 3.0 metre back wall, 1.8 metre side walls and 2.3 metre height
- Colour:** Grey or black (depending upon availability at time of confirmation)
- Power:** 1 x 10amp with 4 pin multi box
- Lighting:** 2 x 150w spotlights
- Signage:** ID Fins Exhib company name and stand number





## Product Listing/Category

We will produce a product/service category listing to help delegates find products/health conditions and services. This will be cross-referenced with the exhibition stands. If you attended last year's meeting you will be automatically listed under the same categories (see the Sponsorship/Exhibition Form on page 17) for the category options.

If you did not attend last year (or did not list your preference), please indicate which categories you would like to be listed under on the exhibition form.

## Prizes

We will list any prizes/competitions/giveaways you are offering from your stand. We include these details in the conference proceedings and on the main information board to give delegates a heads up on what is happening around the exhibition area. This will also help as a conversation starter and may reduce the need for repetition re introducing the prize/competition when delegates arrive at your stand.

We can notify winners of your competition onsite, prior to the final catering session on Sun 13 June, and encourage them to visit your stand to collect their prize prior to leaving the conference. We can only do this for exhibitors who advise us what competition they are running.

You will need to advise the winner of your competition to us at the conference registration desk by 9am on Sun 13 June.

Deadline for receiving your prize/competition details is **Fri 07 May 2010**.

## Delegate Flow Conference Competition

To encourage delegate flow in all areas we are running a stamp competition

Each exhibitor will be issued with a conference stamp, with your own name printed on a self-inking stamper. Delegates will need to obtain a stamp from all exhibitors to enter the draw for either:

- Family holiday to Rarotonga, or
- Registration and travel for GP CME 2011 (June, 2011, Rotorua Energy Events Centre)



The entry form will be a page in the conference proceedings.



## Other Sponsorship options

**Conference Proceedings Ads** ..... **Included with exhibition space**  
As an exhibitor/sponsor you are entitled to an ad insert in the Conference Proceedings as per the following:

**Ad sizes:** Single Space (Stand/Table) - 1/4 Page: (Width) 80mm x 127mm (Height)  
Silver Sponsor/Double Space - 1/2 Page: (Width) 180mm x 135mm (Height)  
Gold Sponsor/Triple Space - 1 x Full Page: (Width) 180mm x 270mm (Height)  
Platinum Sponsor/Triple Space - 2 x Full Page: (Width) 180mm x 270mm (Height)

**Satchel Insert** ..... **\$500+GST**

- A4 or smaller insert into conference satchel
- List of delegates attending with contact details from those who have given permission

**Satchel Sponsor** ..... **\$1,000+GST**

Plus 700 satchels at cost

- Logo acknowledgement on conference satchels
- Acknowledgement on registration brochure, website and proceedings as Satchel Sponsor
- Content on CD ROM
- List of delegates attending with contact details from those who have given permission
- Full page ad in conference proceedings if not already an exhibitor

**Name Tag Sponsor** ..... **\$2,500+GST**

Plus cost of production

- Logo acknowledgement on name labels (must be worn by all attendees)
- NZMA logo will be on the name labels lanyard (necklace)

**Room Drop** ..... **\$1,000+GST**

Fri and Sat nights only

- Personalised gift/message left in each delegates' room at conference hotels
- List of delegates attending with contact details from those who have given permission



## Other Sponsorship options

**Welcome Cocktail Function** .....\$2,000+GST

- Naming rights to the Welcome Function
- Acknowledgement and introduction at the Welcome Function
- Opportunity to address the participants at the function
- List of attendees at Cocktail Function, and addresses from those with permission
- 1/2 page ad in conference proceedings if not an exhibitor

**Conference Dinner Function** .....\$5,000+GST

- Naming rights to the Conference Dinner Function
- Acknowledgement and introduction at the function
- Opportunity to address the participants at the function
- List of attendees at Conference Dinner, and addresses from those with permission
- Full page ad in conference proceedings if not an exhibitor

**CDROM/DVD Sponsorship**.....\$1,000+GST

- Logo placement on Conference CDROMs/DVDs acknowledging support (distributed to all attendees after the conference)
- List of attendees and addresses from those with permission

**Registration Brochure**..... \$1,500+GST for a full page ad

- Full Page ad in Registration Brochure distributed within NZ Doctor in Feb 10 and April 21 Editions (if not confirmed by Platinum Sponsor).

**Highlighters**.....\$1,500+GST

- Promotional highlighter comes with 5 highlighter ends - Orange, Pink, Blue, Green, & Yellow  
Company logo on highlighter inserted in all delegates bags

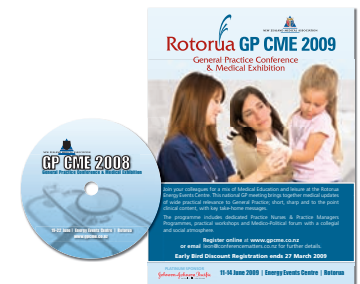

## Other Sponsorship options

**Internet Station** .....\$2,250+GST

- 4 Computers linked to an internet hub,
- Internet connection and Cabling,
- Black & White laser Printer
- Includes Signage (with your approval), screen saver with Company details and home page set with Company details

**Pocket Programme**.....\$2,250+GST

- This information will include conference programme, map of Rotorua, opening times for displays and exhibits, hotel check-in and check-out times, details of local restaurants and useful contact phone numbers

**Coffee Cart Sponsorship**.....\$2,250+GST per coffee cart (2 available)

- Company Signage on Coffee Cart
- Acknowledged as Coffee Cart sponsor on Floor Plan
- Acknowledgement on conference communication to delegates to 'Get your daily dose from the Company Coffee Cart'
- List of attendees and addresses from those with permission



## Exhibition/Sponsorship Application

Applications for exhibition/sponsorship participation can be made on the enclosed form. Upon receipt a GST invoice/receipt will be forwarded confirming your participation. All space is allocated on a first-in first-served basis with preference to Platinum, Gold and Silver participants.

The organisers reserves the right to change the floor plan to ensure exhibitors receive the best exposure possible with delegates and catering stations encourage foot traffic in all areas.





#### Cancellation

Cancellations received in writing prior to 26 March 2010 will be refunded all monies paid less an administration fee of \$50. After this date no refunds will be made. The organisers reserve the right to cancel the exhibition due to events or circumstances beyond their control. All monies received will be refunded in full in this situation.

#### Catering

All catering and functions (except the Conference Dinner) will be held amongst the trade/exhibition display areas. The organisers will work with the catering company to ensure all positions receive the best possible exposure with delegates. All exhibitors will be catered for 30min prior to the scheduled catering breaks.

#### Internet Access

Internet connections (dialup and broadband) are available to your stand space at the Rotorua Energy Events Centre. Cost is payable (\$200+GST) prior to the meeting.

#### Insurance

It is the responsibility of each sponsor to ensure that their stand and goods on display are adequately insured for theft and damage.

#### Security

General site and access security will be provided for all exhibition by the Rotorua Energy Events Centre staff. Security of your exhibition site during the day is individual responsibility.

#### Conference Proceedings Ads

As an exhibitor/sponsor you are entitled to an ad insert in the Conference Proceedings as per the following:

**Ad sizes:** Single Space (Stand/Table) - 1/4 Page: (Width) 80mm x 127mm (Height)  
Silver Sponsor/Double Space - 1/2 Page: (Width) 180mm x 135mm (Height)  
Gold Sponsor/Triple Space - 1 x Full Page: (Width) 180mm x 270mm (Height)  
Platinum Sponsor/Triple Space - 2 x Full Page: (Width) 180mm x 270mm (Height)

**Colour:** Full Colour

**Format Artwork:** High resolution PDF preferred. Artwork created by any of the following applications are accepted as well as any other program that produces the same type file formats:

Adobe Illustrator, Pagemaker, Freehand, Photoshop.

**Material Deadline:** 5pm Friday 7 May 2010

**Deliver to:** Email: [leon@conferencematters.co.nz](mailto:leon@conferencematters.co.nz)

#### CDROM Content

Principal Sponsors, Satchel and Conference Dinner sponsors are able to provide content to include on the delegates' CD ROM. This content can be a PDF of a print ad, digital video of a TVC (mpg or avi format) or other text and images.

**Material Deadline:** 5pm Friday 7 May 2010

**Deliver to:** Email: [leon@conferencematters.co.nz](mailto:leon@conferencematters.co.nz)  
or Physical address: 3 Haronui Street, Whangarei 0112

#### Registration and Accommodation

All attending company representatives must be registered for the meeting, including complimentary registrations. The registration form will be available in February 2010, with an option to register online. Each exhibitor will receive one free exhibition registration per trade stand purchased.

This includes:

- Name Badge
- List of participants
- Conference Programme
- Morning and Afternoon Teas
- Lunches

All other booth personnel must register at a fee of \$375 per person.

Tickets to social functions can also be purchased by exhibitors – these will be listed on the conference registration form. Group discounted rates have been negotiated with Millennium Hotel, Sudima Hotel and the Novotel Hotel. You must book your accommodation through Conference Matters on the registration form to receive the discounted rate.

#### Stand Equipment

If you require any stand equipment, including power, panels, lighting etc, please contact:

Paul Kay  
Alpha Displays  
Mob: 0274 951 053  
Fax 07 345 4341  
Email: [info@alphadisplays.co.nz](mailto:info@alphadisplays.co.nz)



# 10-13 June 2010 Rotorua Energy Events Centre

## Delivery & Storage Details

You can send equipment/brochures to the Events Centre to arrive no earlier than Mon 7 June 2010 as follows:

To: GP CME 2010  
Company Name, Stand Position  
Box 1 of X  
Rotorua Energy Events Centre  
Queens Drive, Government Gardens  
Rotorua  
Ph 07 349 5141

All equipment brochures must be picked up by 5pm Monday 4 June 2010. Any material still uncollected by this date will be deemed unwanted and disposed of appropriately.

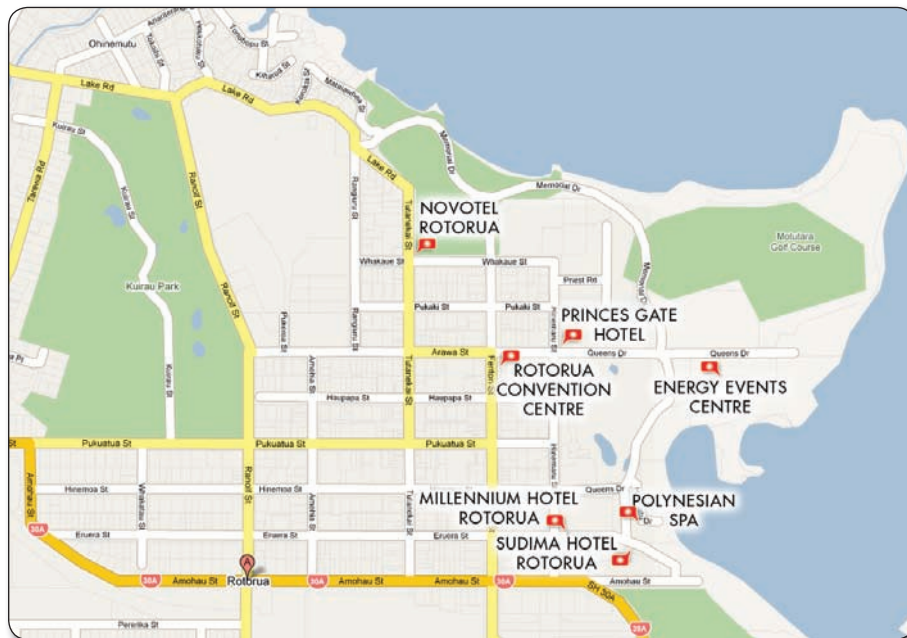

## Timetable

DATE	DETAILS	TIME
Mon 01 Feb	Registration Opens	
Fri 26 Mar	Early Bird Discount ends (delegates only)	
Fri 07 May	CDROM Material Deadline	
Fri 07 May	Conference Proceedings Ad Deadline Prizes and Product Category listing deadline	
Fri 28 May	Late Registration Fee applies (delegates only)	
Thu 10 June	Optional Workshops (delegates only)	8:30am - 6:00pm
	Exhibitor Setup	12:00pm - 9:00pm
Fri 11 June	Registration	7:30am
	Conference	8:30am - 5:30pm
	Practice Managers Programme	8:30am - 5:30pm
	Cocktail Function	6:00pm - 7:00pm
Sat 12 June	Plenary Breakfast	7:00am - 8:15am
	Conference	8:30am - 5:30pm
	Practice Nurses Programme	8:30am - 5:30pm
	Conference Dinner	7:00pm - 12:00am
Sun 13 June	Plenary Breakfast	7:00am - 8:15am
	Prize Winner notification Conference*	9:00am 8:30am - 1:00pm
	*Industry can packout after final catering session at 11am.	
Mon 14 June	Courier pickups+	5:00pm
	+All equipment/brochures must be picked up by 5pm Monday 14 June 2010. Any material still uncollected by this date will be deemed unwanted and disposed of appropriately.	



## Advert Specifications

### Single Stand Space: 1 x Quarter Page

1/4 Page: (W) 85mm x 128.5mm (H) - Portrait

### Silver Sponsor/Double Space: 1 x Half Page

1/2 Page: (W) 180mm x 128.5mm (H) - Landscape

### Gold Sponsor/Triple Space: 1 x Full Page

(W) 180mm x 267mm (H) - Portrait

### Platinum Sponsor/Triple Space: 2 x Full Page

(W) 180mm x 267mm (H) - Portrait

**Colour:** Full Colour

*(Spot colours will vary during process conversion)*

**Format Artwork:** High resolution PDF preferred.

If you are doing a full page A4 advert with bleed. Then the trim size is 210 x 297mm plus 2.5mm bleed.

Type area 190 x 277mm (10mm margins).

Or with no bleed (White page borders)

Then the advert size is 180 x 267mm

Type area of 170 x 257mm (10mm margins)

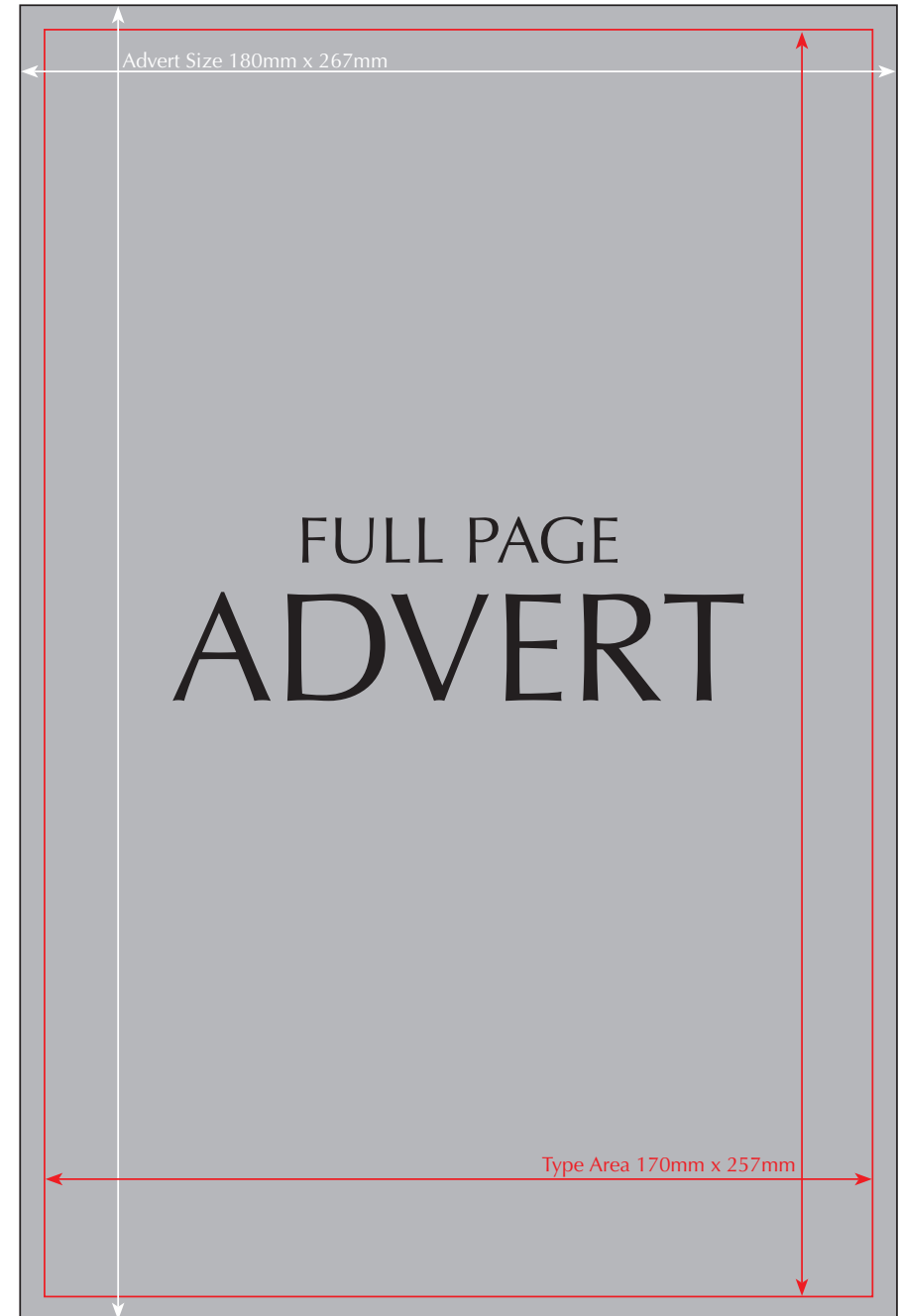
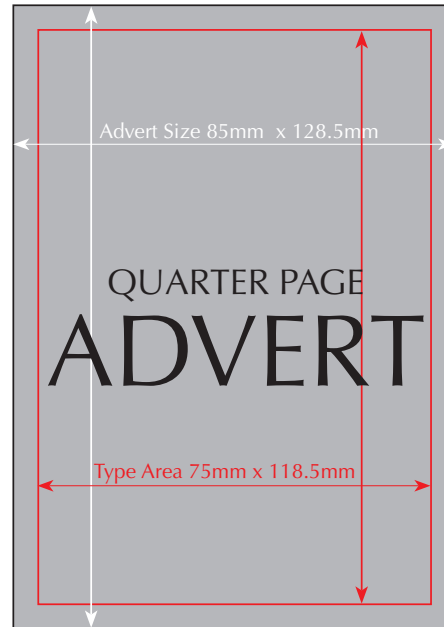





# EXHIBITOR GOODS DELIVERY LABEL

**TO:**

Rotorua Energy Events Centre  
Queens Drive, Government Gardens  
Rotorua 3010  
New Zealand

**Box Number** \_\_\_\_\_ of \_\_\_\_\_

**FROM: SENDER DETAILS**

**Company Name:** \_\_\_\_\_

**Address:** \_\_\_\_\_

**Contact Person:** \_\_\_\_\_

**Phone No:** \_\_\_\_\_

**Email:** \_\_\_\_\_

**Event Name:** GP CME 2010

**Venue:** Unison Arena

**All goods to be received from:** Mon 07 June 2010

**Exhibitor Name:** \_\_\_\_\_ **Stand No:** \_\_\_\_\_

**Contact Person on the day:** \_\_\_\_\_ **Mobile No:** \_\_\_\_\_

**Delivery & Storage:** The Rotorua Energy Events Centre will not permit any goods to be delivered to the venue earlier than the date specified above. Deliveries prior to this date will be turned away.

All equipment/brochures must be picked up by 5pm Monday 14 June 2010. Any material still uncollected by this date will be deemed unwanted and disposed of appropriately.

Event Venues (Rotorua Energy Events Centre) Ph +64 (0)7 349 5141



Previous

Index

  
CONFERENCE MATTERS

Postal: PO Box 1661  
Physical: 3 Haronui Street, Whangarei  
Phone: +64 (021) 164 3815  
Fax: +64 (09) 437 4089  
Email: [leon@conferencematters.co.nz](mailto:leon@conferencematters.co.nz)  
Web: [www.conferencematters.co.nz](http://www.conferencematters.co.nz)